

February 2025  
Scheduled to open

Connecting the Sky and the Land,  
Office Buildings of new era

# ANAスカイコネクトなんば

ANA SKYCONNECT NAMBA

"ANA Sky Connect Namba" is a futuristic building facing Nansan Street, which is converted into a pedestrian space, with an emphasis on liveliness and comfort. With excellent access to Kansai International Airport, it contributes to the local community as a new hub for business and cultural exchange.

Nankai Main Line  
"Namba" station **1** Minute walk

Midosuji Line  
"Namba" station **6** Minutes walk

Official HP



## LOCATION



Facing "Nansan Street" leading from the station square.

## FACADE



A café is planned to be attracted on the first floor.

## SHARED OFFICE



The first ANA shared office "ANA WORK CABIN" opened



**ANA** ANA FACILITIES CO.,LTD.

Real Estate Broker (Minister of Land, Infrastructure, Transport and Tourism(4)No.7278)  
〒530-0001 Breeze Tower, 2-4-9 Umeda, Kita-ku, Osaka-shi, Osaka  
Type of transaction: Lender

Contact: Segawa (Real Estate Planning Department)  
TEL 06-7739-2990  
E-mail ml\_notice\_anaskyconnect@anaf.co.jp  
Office hours: Monday-Friday 9:00-18:00,  
closed on Saturdays, Sundays, and holidays

## Northeast side of Namba Station Outline of Pedestrian Spatialization Plan



By the end of FY2024, A portion of Nansan Street is being converted to a pedestrian-only street and the sidewalks are being widened. The aim is to create a space with a sense of continuity and high quality from the plaza in front of the station. The image of Nansan Street will be greatly changed by undergrounding utility poles and power lines.

## Floor Plan/Terms of Application

### Floor Plan 3~8F

### Floor Plan 9F

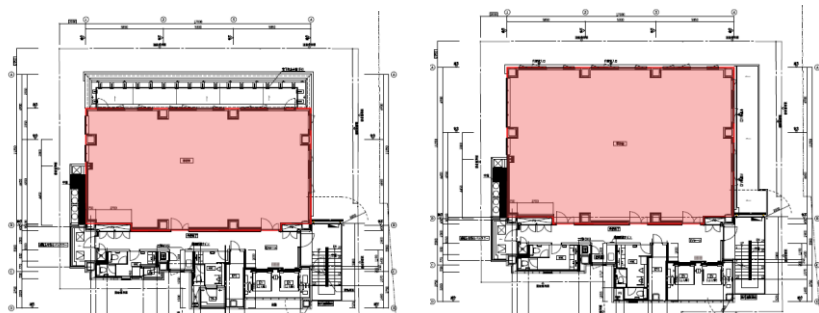

**Floor Space** 3~8F/59.56tsubo,9F/46.44tsubo  
**Rent** 20,500yen/tsubo  
**Common Charges** 2,500yen/tsubo  
**Deposit** 12 months

## Outline of Property

Name	ANAスカイコネクトなんば-ANA SKYCONNECT NAMBA-
Location	1510-11 Sennichimae, Namba, Chuo-ku, Osaka-shi, Osaka
Nearest Station	Nankai Main Line "Namba" Station, 1 minute walk
Use	Office (office area: 3F-8F 59.56 tsubo ,9F 46.44 tsubo)
Structure	Steel construction, 9 floors above ground
Completion	February 2025 (scheduled)
Designed and Constructed	ASAI Architect Office Co., Ltd & ICHIKEN Co., Ltd.

## Outline of Equipment

Common Facilities①.②	EV (2 passenger units, 1 of them for welfare) ・ WC ・ Kitchenette
	Smoking area (2nd floor)
Ceiling Height	Standard floor: After construction of OA floor 2,800mm
Floor Load	500kg/m <sup>2</sup>
Entrance and Exit Control	Machine security (security card + key box control system)
Entrance opening/closing time(scheduled)	Weekdays 8:00 - 20:00 Saturday 8:00 - 18:00 Closed on Sundays and holidays The service entrance is available by using a security card for 24 hours a day, 365 days a year
Air conditioning	Packaged individual air conditioning system (4-way ceiling cassette), 1 system/floor

**ANA** ANA FACILITIES CO.,LTD.

Real Estate Broker(Minister of Land, Infrastructure, Transport and Tourism(4)No.7278)  
 〒530-0001 Breeze Tower, 2-4-9 Umeda, Kita-ku, Osaka-shi, Osaka  
 Type of transaction: Lender

Contact: Segawa (Real Estate Planning Department)  
 TEL 06-7739-2990  
 E-mail ml\_notice\_anaskyconnect@anaf.co.jp  
 Office hours: Monday-Friday 9:00-18:00,  
 closed on Saturdays, Sundays, and holidays